

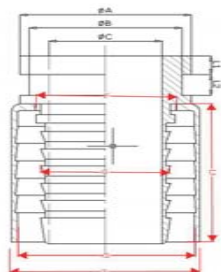



## Victaulic Couplings



Victaulic couplings are supplied with grooved or shouldered ends to permit fast installation without field preparation. We can supply various specification according to customer's requirement.

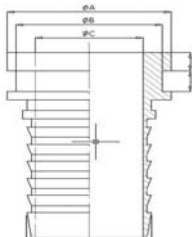

Luxecasting2014	Name	Size	Code	ΦA mm	ΦB mm	ΦC mm	G mm	L1 mm	L2 mm	Price USD
 	VIC60/55CS	2"-2"	L0901001	60	57	55	55	16	18	
	VIC73/55CS	2 1/2"-2"	L0901002	73	65	48	55	11	12	
	VIC60/67CS	2"-2 1/2"	L0901003	60	57	52	67	16	18	
	VIC73/67CS	2 1/2"-2 1/2"	L0901004	73	65	48	67	11	12	
	VIC90/67CS	3"-2 1/2"	L0901007	90	82	60	67	16.5	18	
	VIC90/80CS	3"-3"	L0901005	90	83.7	72.5	80	17	18	
	VIC97/80CS	3 1/4"-3"	L0901008	97	89	72.5	80	17	18	
	VIC114/86CS	4"-DN80	L0901006	114.3	108	79	85.5	17	18	
	VIC114/107CS	4"-4"	L0901009	114.3	108	98	106.5	17	18	
	VIC127/107CS	4 1/2"-4"	L0901011	127	114.3	98	107	17	18	
	VIC148/133CS	5 1/2"-5"	L0901010	148	139	123.5	133	17	18	

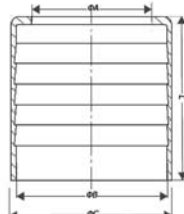
Ferrule	Name	size	Code	ΦA mm	ΦB mm	ΦC mm	L3 mm	Price USD
 	VIF60/75SS	2"	L0902001	59.8	75	80	80	
	VIF77/91SS	2"-2 1/2"	L0902002	76.5	91	99	118	
	VIF81/91SS	3"-2 1/2"	L0902003	82	91	99	118	
	VIF102/111SS	4"-DN80	L0902004	102	111	118	134	
	VIF87/106SS	3"	L0902005	87	106	114	129	
	VIF113/137SS	4"	L0902006	113	137	145	142	
	VIF121/137SS	4 1/2"	L0902008	121	137	145	142	
	VIF142/160SS	5"	L0902007	142	160	167	144	